

Contact: Denis Durepos  
506.473.9258  
denis@broadway-place.com  
[www.broadway-place.com](http://www.broadway-place.com)

## Commercial Property

837 Champlain - Dieppe



- 9,375 sqft multi-tenant
- Warehouse building with Office Space
- Natural Gas & Electric Heating
- In House Keying System
- Lighted Signage available
- 20' Ceiling Height
- Available Parking
- Fenced in Compound
- Grade Level & Dock Level Garage Doors available
- In House Maintenance: 24 hour turn around time on major problems
- Centrally located to Dieppe, Moncton, Wheeler Blvd and TCH
- Available Spaces range from 937sqft, 1,875 sqft and 3,750 sqft.
- Will sub-divide to accommodate tenant needs
- Turn key finishes/options available



Existing Front building



\*New Construction 2015

Broadway Place Ltd has been in the property ownership/management business since 1976. We currently own over 380,000 sqft of building space throughout New Brunswick. Our clients include the Province of New Brunswick, Government of Canada, Shoppers Drug Mart, Schneider Electric and Loomis. Some of our buildings in Dieppe include 323 Champlain & 105 Englehart. In Moncton, we own 555 & 535 Edinburgh Drive.

JOINT UTILITY EASEMENT

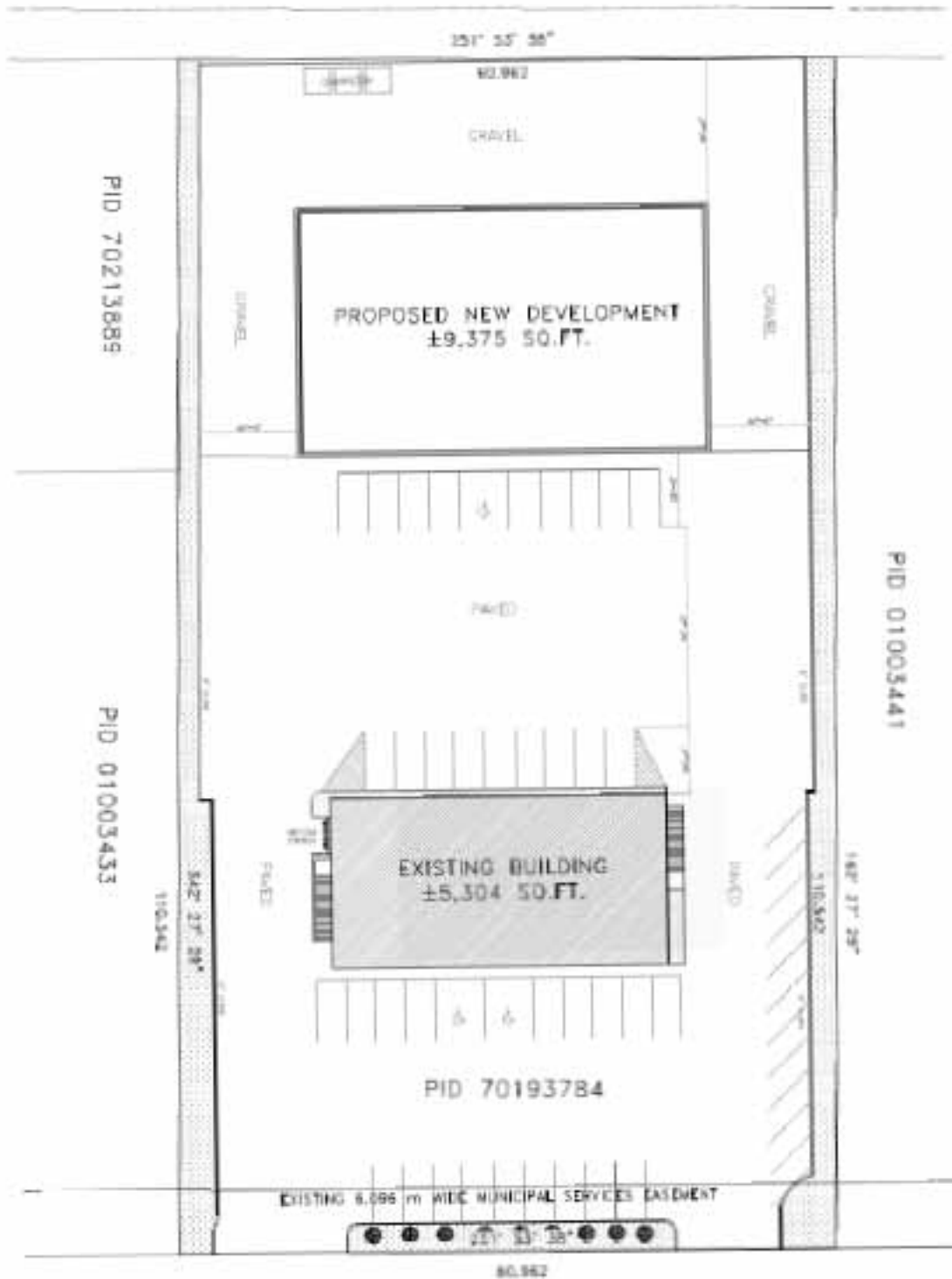

RUE CHAMPLAIN STREET